

HIGH STEER GM 10-BOLT STEERING KNUCKLE

Reid Racing's high-steer Chevy "10-Bolt" knuckles are designed with both cast-in steering arms and machined flat-tops to be used in full high steer applications using aftermarket bolt-on steering arms. They use the Chevy / Jeep spindle bolt pattern and will accept "outers" from all open knuckle Full-Size Jeep and Chevy Dana 44 & 10-Bolt solid axles from 1978 to 1991. They use the same casting as our Heavy-Duty Chevy Dana 44 knuckles, but the steering arms are tapered so that the tie rod installs from below just like the stock 10-Bolt knuckles. OEM 10-bolt axles varied over the years but the minor differences will not affect the general compatibility.

INSTALLATION

Remove the original knuckles from the vehicle. The original spindle studs can be removed by striking them with a soft faced hammer. New spindle studs are available from Reid Racing (part # D44101K) if needed. Clean and inspect all the original parts, replacing any damaged or worn components. Using a hammer and punch, tap in 6 spindle studs from the back side of the knuckle until fully seated. Install the ball joints, then the knuckle on the vehicle according to a factory service manual making sure to torque all fasteners to the original specs.

4th BOLT HOLE / HIGH STEER

The "flat top" of the Reid Racing 10-Bolt knuckle has been raised 3/8" taller than the factory Chevy top. This helps raise the steering arms to aid in tie rod to leaf spring clearance. A 4th bolt hole has also been added to the top of the Reid Racing knuckle to increase the strength of the high steer arm attachment. Use the drawing below to determine the location of the 4th hole on your steering arms and drill a 9/16" diameter hole. Mount the arms using blue Loctite on the studs and torque them to 100 ft. lbs. Re-torque after the first outing.

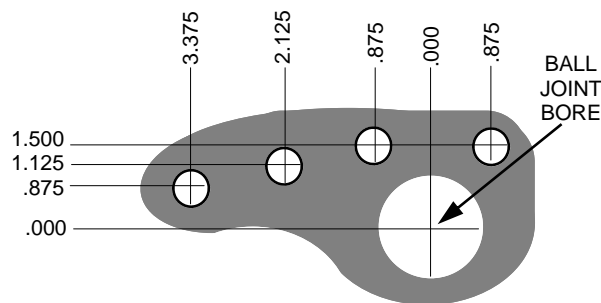

NOTE: If you do not want to modify 3 hole steering arms, simply do not use this bolt hole.

STEERING STOPS

The steering stops on Reid Racing knuckles are "cast in" to prevent the common bending of the stock style adjustable bolts. The stops are intentionally cast long so adjustments can be made by grinding the tips of the stops to fit. After the knuckles are installed and the toe in is set, cycle the steering back and forth grinding small amounts of the stop until the desired degree of steering is set. Make sure to check for u-joint binding and yoke to yoke interference at full lock in both directions; if binding or contact occurs, axle breakage will happen. If a stock style adjustable steering stop is desired, the cast in stop can be cut off at the knuckle then drilled and tapped for a 3/8" bolt.

WARRANTY

All "Off Road Products" sold by Reid Racing, Inc. are intended to be used for "off road" and "off highway" use only, and are NOT designed, manufactured or approved for use on any public road or highway. Due to the intended use of the products offered, all "Off Road Products" are sold without any warranties of fitness for purpose or use, merchantability, or any other kind, either expressed or implied, whether written or oral, by Reid Racing, Inc., or its past, present or future officers, directors, principals, agents, employees, legal representatives, trustees, parents, associates, affiliates, subsidiaries, division, partners, heirs, executors, administrators, purchasers, predecessors, or successors. The buyer of these "Off Road Products" bears and assumes the entire risk of loss or injury as to the fitness for purpose or use, merchantability, durability and performance of these "Off Road Products" and assumes the entire cost of any necessary maintenance, service or repair. Reid Racing, Inc. will not be liable for any subsequent, resulting or consequential damages, expenses, losses or injuries arising from or out of the use, misuse, or improper installation of any "Off Road Product".